



CONSTRUCTION  
INDUSTRY COUNCIL  
建造業議會

# Leveller Intermediate Trade Test Mock Practical Test Paper

此文件關於平水中工工藝測試考題。如有需要索取此文件的中文版本，請致電 2100 9000 與香港建造業工藝測試中心聯絡。

## **Disclaimer**

*No part of this material may be reproduced or transmitted in any form or any means without the written permission of the CIC. Whilst reasonable efforts have been made to ensure the accuracy of the information contained in this material, the CIC nevertheless would encourage readers to seek appropriate independent advice from their professional advisers where possible and readers should not treat or rely on this material as a substitute for such professional advice for taking any relevant actions.*

## **Enquiries**

Enquiries on this Material may be made to the Hong Kong Construction Industry Trade Testing Centre at:

95, Yue Kwong Road  
Aberdeen  
Hong Kong

Tel: (852) 2100 9000  
Fax: (852) 2100 9090  
Email: [enquiry@cic.hk](mailto:enquiry@cic.hk)  
Website: [www.cic.hk](http://www.cic.hk)

© 2020 Construction Industry Council.

## Intermediate Trade Test Paper

Post : Leveller

Grade : Semi skilled worker

Test Content : Complete the following tasks at designated location :

1. Setting out: Setting out of elements, marking, and writing of descriptions. (85 marks)

(a) Setting out on ground according to the attached drawing at designated location.

(b) Setting out of the profile of elements on wall according to the attached drawing including treads, risers , waist of upper flight stair, beams, landings and concrete walls.

2. Use of Instrument (15 marks)

Setting up a level in an appropriate location, levelling and setting right to the target (staff), focusing and eye piece adjustment. After checked by invigilator, pack up the level back to the case.

Duration : 3 Hours

- Notes :
- (1) Candidate should read the attached “Notes to candidate” before commencement of work.
  - (2) Candidate will fail if he conducts the test without safety precautions.
  - (3) There are 4 pages. Total score is 100. Passing mark is 60.

# LEVELLER

## Intermediate Trade Test

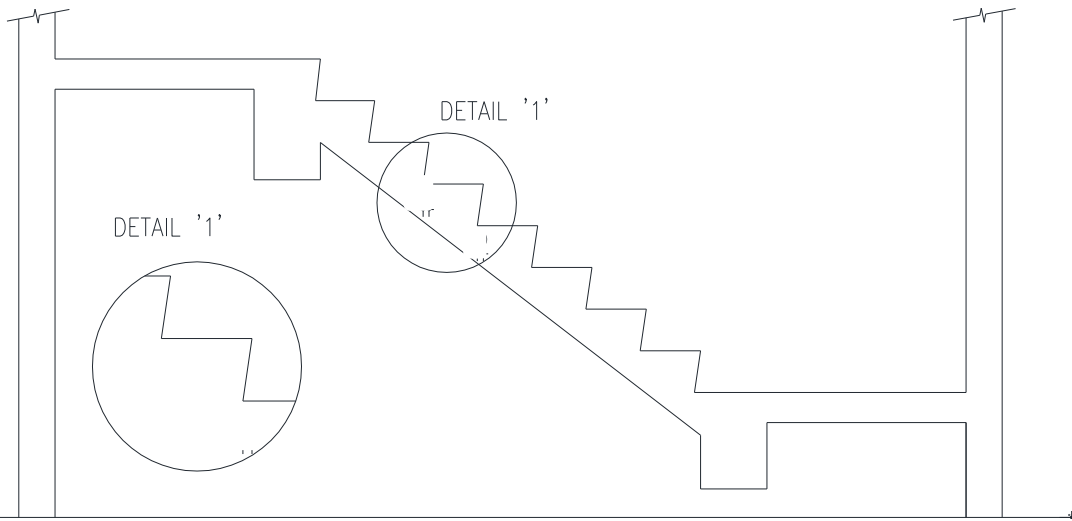

SECTION A-A

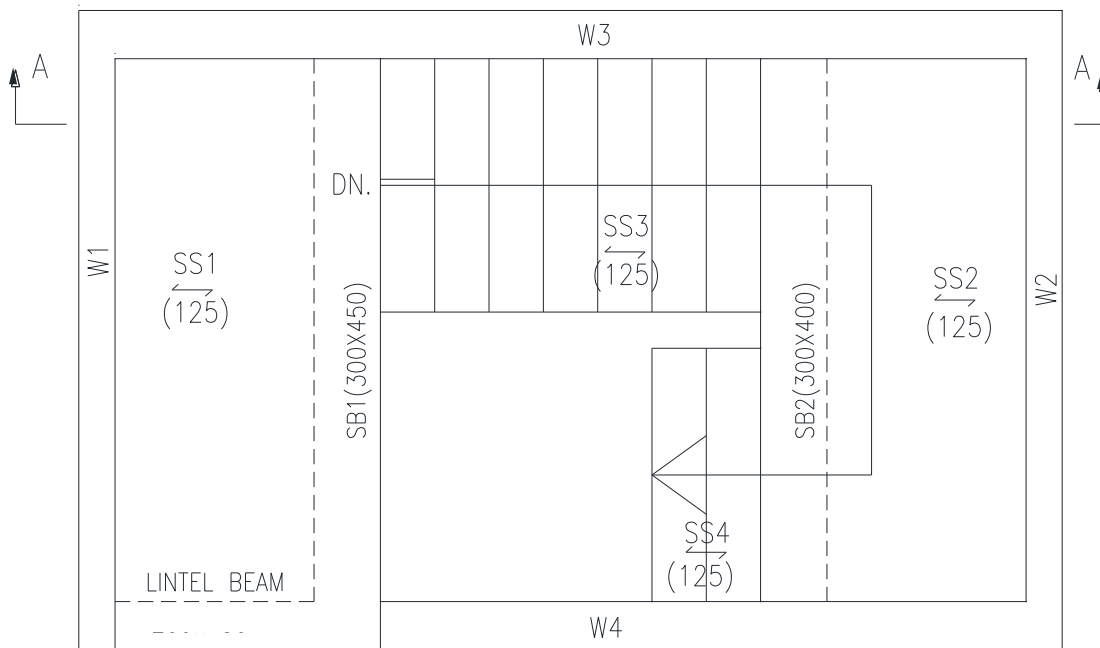

PLAN (1:30)



All dimensions in mm

Notes to Candidates :

Part A

1. Candidates should read the test papers carefully and ask the invigilator for any queries.
2. Candidates should study the drawings and specifications attached to test papers, if any, before the test begins.
3. Candidates should carry out the test according to test papers, working drawings and specifications provided.
4. Candidates shall bring their own safety shoes, other safety equipment will be provided by trade testing centre. Candidates must take all necessary safety precautions to ensure work safety.
5. All tools and materials required by the test will be provided by trade testing centre, candidates should check and ensure their adequacy and quality. Candidates shall use the tools and materials properly based on trade practice. All the tools must be returned to trade testing centre after the test. The candidates may ask the invigilator for any problems.
6. Candidates are required to handle and move the tools and materials for use in the test, and to carry out associated works.
7. Invigilator will take record photos periodically during the test.
8. Candidates are not allowed to take any photo or video with cameras or mobile phones.
9. Candidates are not allowed to use their mobile phones during the trade tests, except for emergency situation.

10. The marking scheme is based on the following criteria :
  - a) Understanding of drawing and specification
  - b) Preparation works before commencement of test
  - c) Working procedures
  - d) Accuracy and quality of works
  - e) Progress of works
  - f) Proper handling and use of materials
  - g) Proper use of tools and equipment
  - h) Safety precautions
  - i) Considerate of other trades
  - j) Housekeeping after completion of test
11. All candidates must stop when time is up.
12. Candidates are required to return the test paper to invigilator after the test.
13. Offering bribe to invigilator is an offence in law and trade testing centre will report to the ICAC for any such case.

**In the event that the candidate fails to take any necessary safety precautions and / or works in any dangerous situations, he / she will be assessed failed**

## Part B

1. The sequence of the tasks shall be subject to candidates discretion
2. Setting out at exact dimension. Thickness of finishing shall not be taken into account.
3. Setting out should have sufficient marking and letter description.
4. Ground setting out line and wall setting out line should be correspondent to each other.
5. A level datum line, 600mm from the ground level, has been provided.
6. Red pencil, blue pencil and pencil are allowed to be used on ground measure. Only pencil is allowed to be used on wall measure.
7. Candidates are allowed to amend setting out lines, but the clearance of setting out is included in the marking scheme.
8. Each candidate has an assistant to hold the string of marker and tape. The assistant would not express any opinion during the course of testing. During tape measurement the assistant can only hold the head of tape (zero) or 100, 200.....multiple of 100mm. All dimensions should be measured by the candidate. For line setting, the assistant can only press the string of marker on either side, candidate shall make the line by himself.
9. For any queries, candidates should ask the invigilator.
10. For shortage of materials or problem in tools, candidates may ask for the change or supplement.